



## AVK WAFER DUAL FLAP CHECK VALVE WITH VULCANISED SEAT PN16



Dual Flap check valve with vulcanised seat  
Face to face to DIN 3202-K3  
Body design suits ANSI B16.1 Class 150, AS 4087 and AS 2129 Table E  
Designed to standard BS 5153



**Applications:**

- Water

**Tests:**

- API598

**Temperature range fluids:**

- -10°C to 90°C

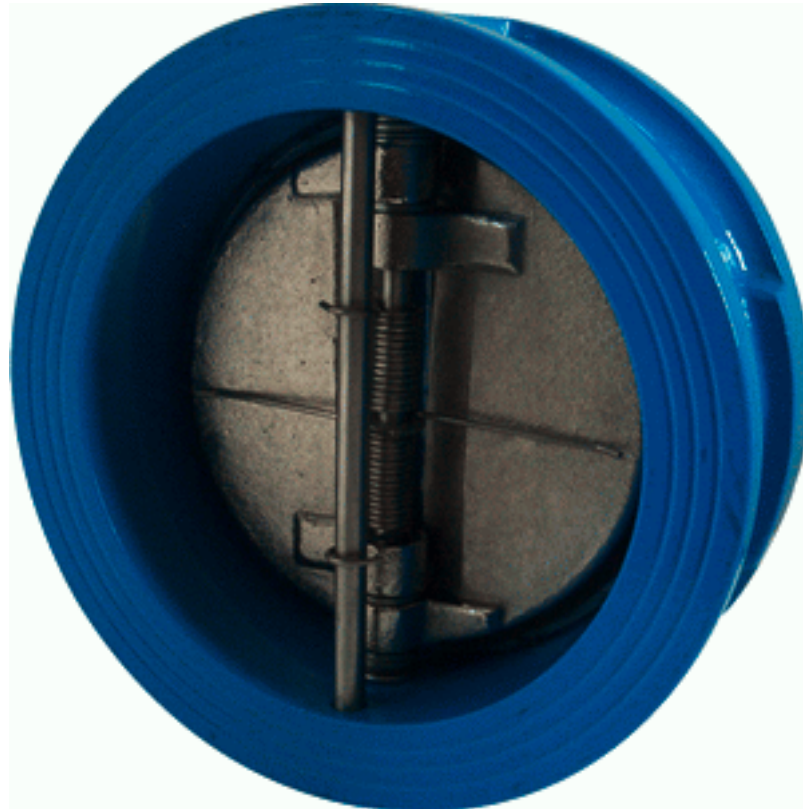

# AVK WAFER DUAL FLAP CHECK VALVE WITH VULCANISED SEAT PN16

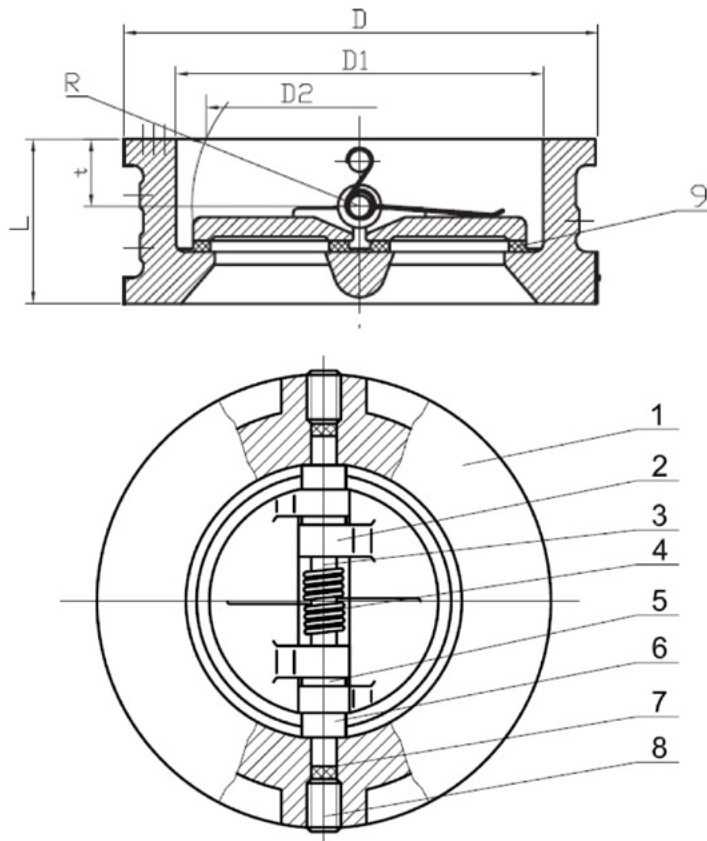

## Component list

1. Body	Cast Iron
2. Disc	Stainless Steel 316
3. Stem	Stainless Steel 316
4. Spring	Stainless Steel 316
5. Washer	PTFE
6. O-ring	EPDM
7. Hex nut	Stainless Steel 316
8. Seat	EPDM

Components can be substituted with equivalent or higher class materials.

## Reference nos. and dimensions

AVK ref. nos.	DN	L mm	D mm	D1 mm	D2 mm	Weight kilos
I2300501301001068400	50	43	96	65	0	1.3
I2300651301001068400	65	46	110	80	60	2.1
I2300801301001068400	80	64	128	94	70	2.9
I2301001301001068400	100	64	156	117	88	4.3
I2301251301001068400	125	70	187	145	115	6.4
I2301501301001068400	150	76	213	171	134	9.1
I2302001301001068400	200	89	267	224	182	15.2
I2302501301001068400	250	114	328	265	220	26.5
I2303001301001068400	300	114	375	310	260	37
I2303501301001068400	350	127	444	360	298	55
I2304001301001068400	400	140	495	410	350	80
I2304501301001068400	450	152	558	450	385	101
I2305001301001068400	500	152	615	505	438	114